

Norm 12

Assembly Instructions

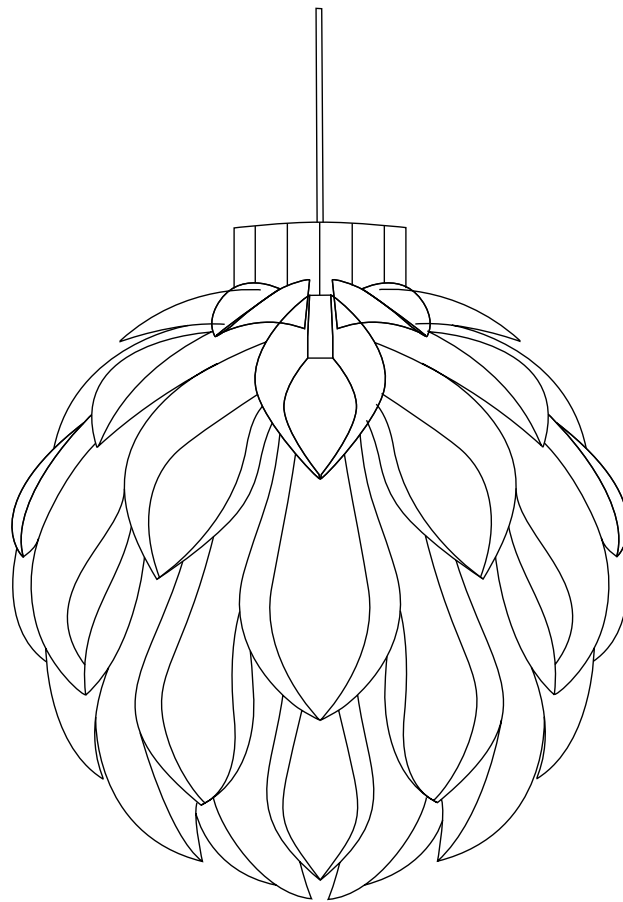

normann

C O P E N H A G E N

1

INFO

The lamp shade is made of a special, non flammable plastic material.

Low-energy 9 Watt (max. 60 Watt) bulb are recommended.

Socket and cord are not included.

Norm 12 can be cleaned with a duster or by using the shower head in the shower.

Watch the Norm 12 Lamp being assembled:

www.youtube.com/normann copenhagen

normann
COPENHAGEN

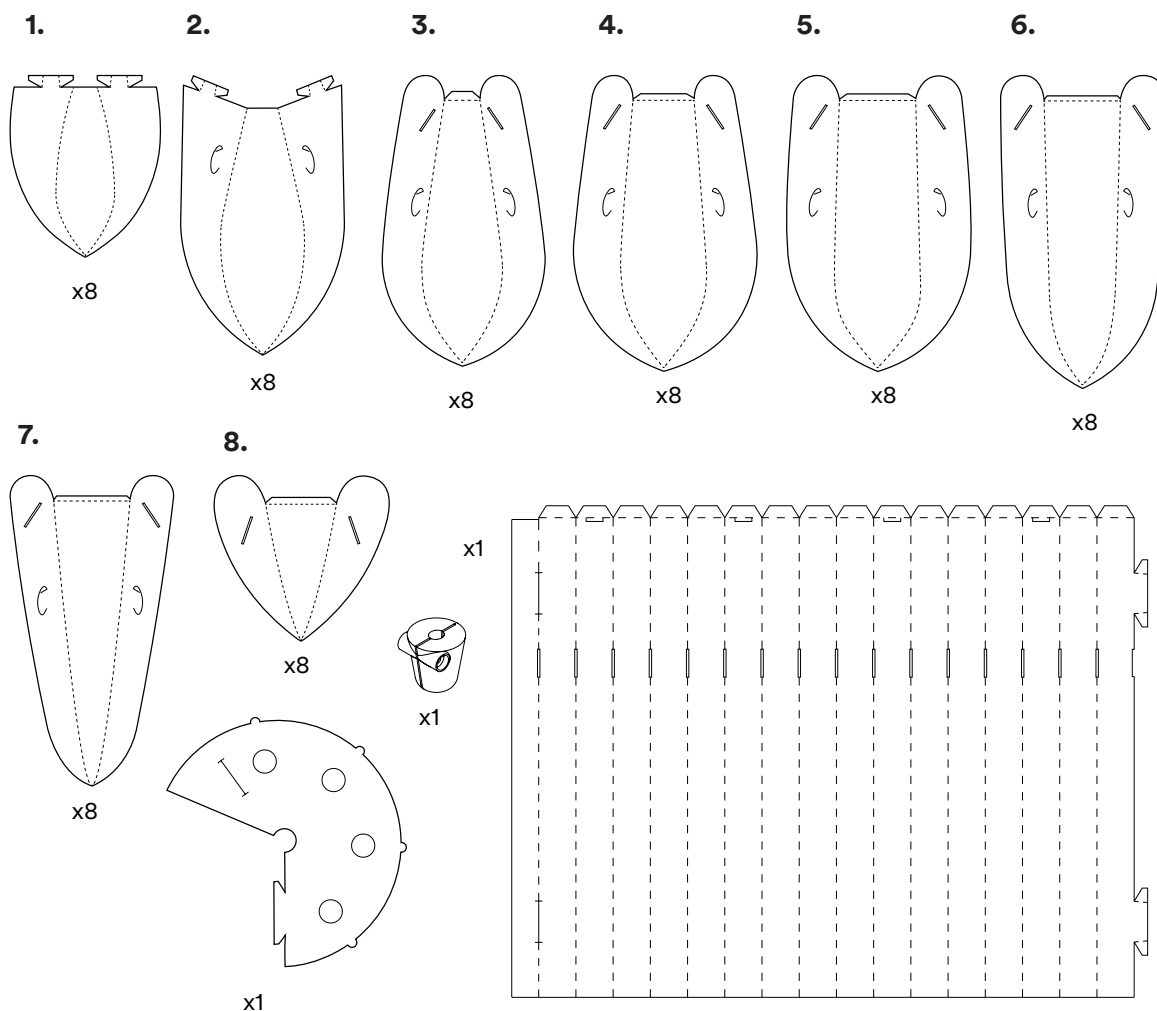

2

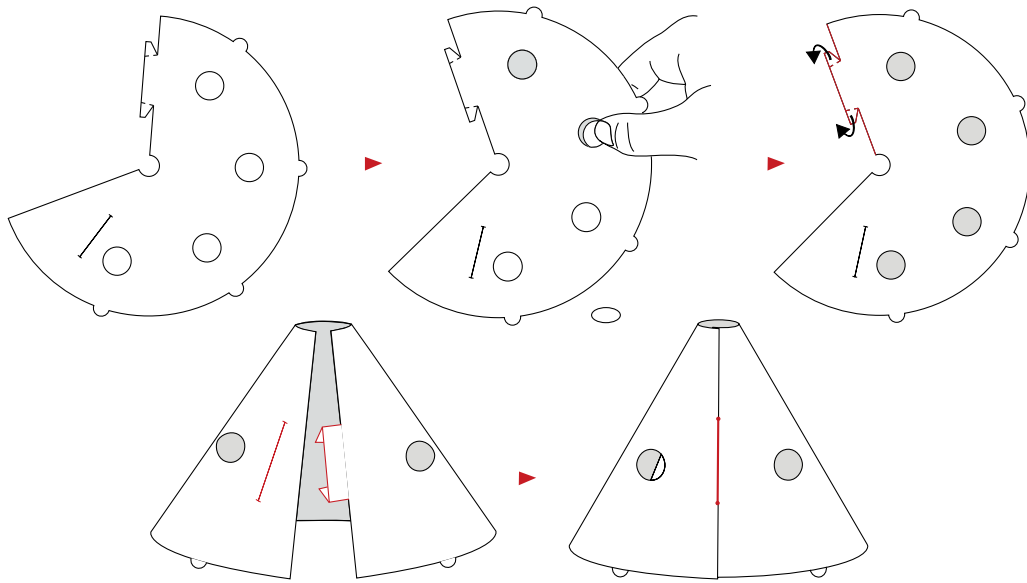

3

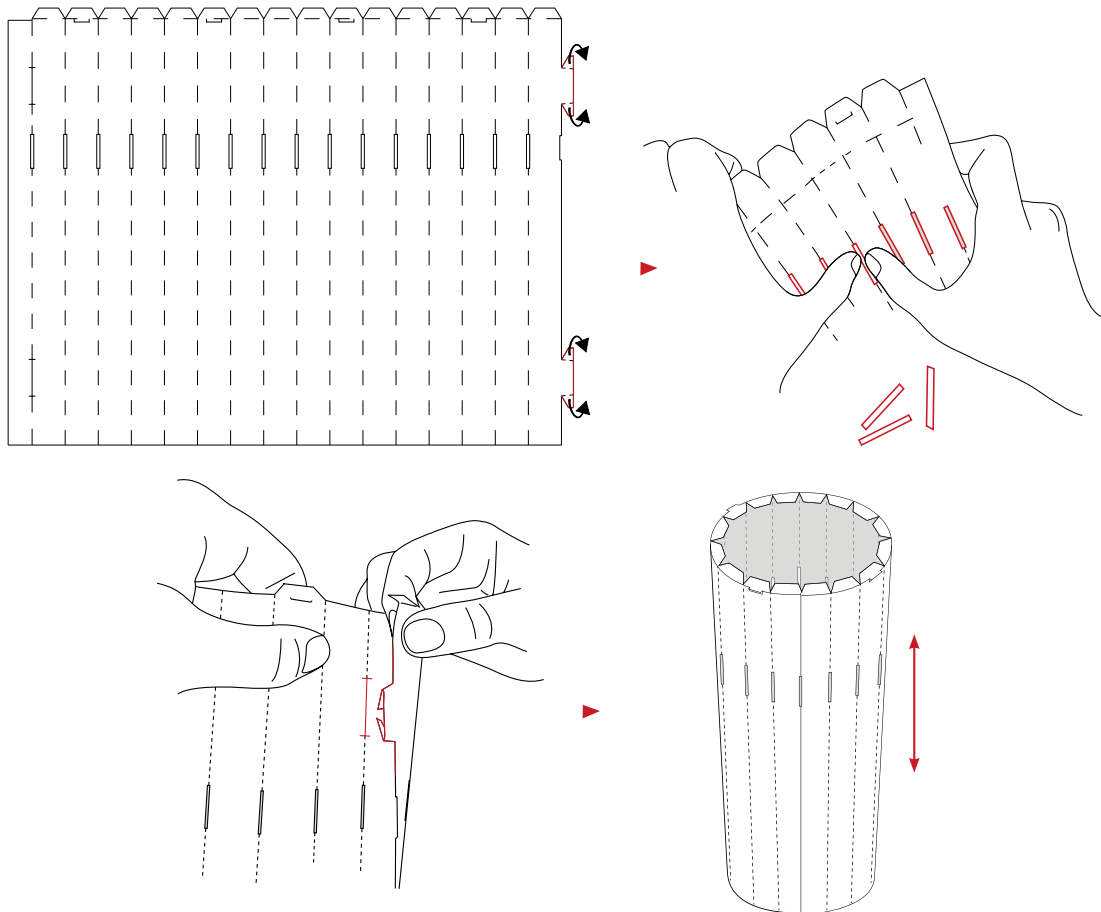

4

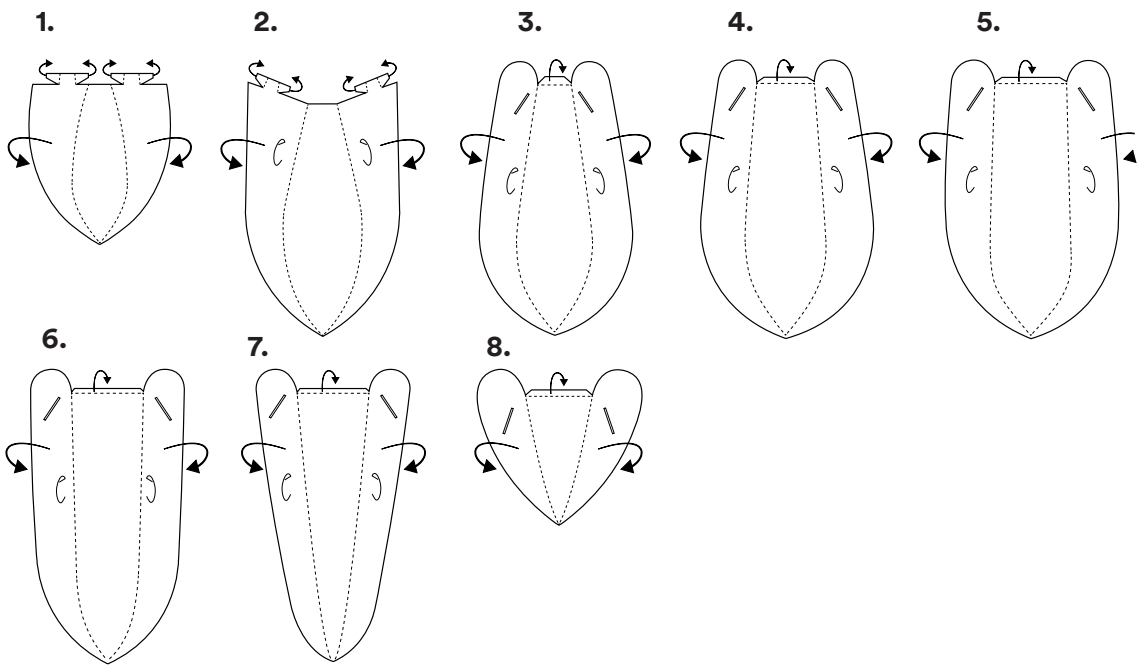

5

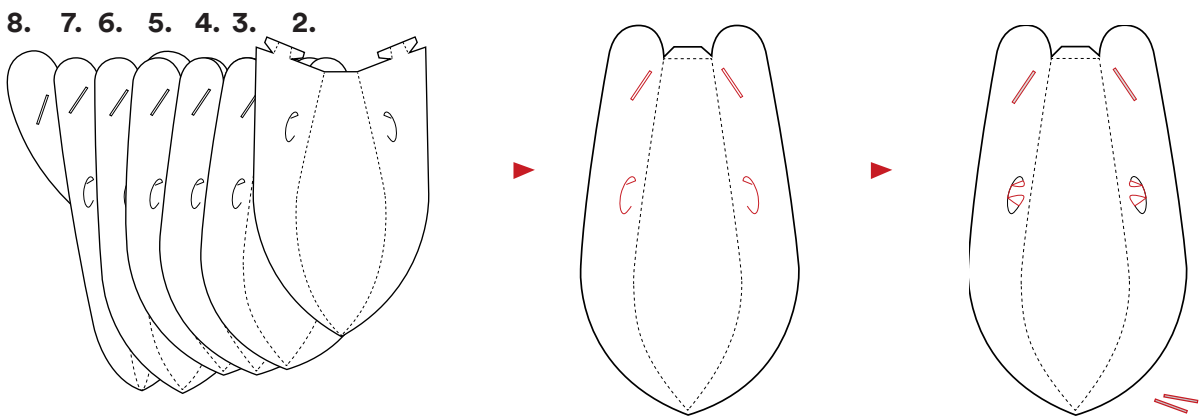

6

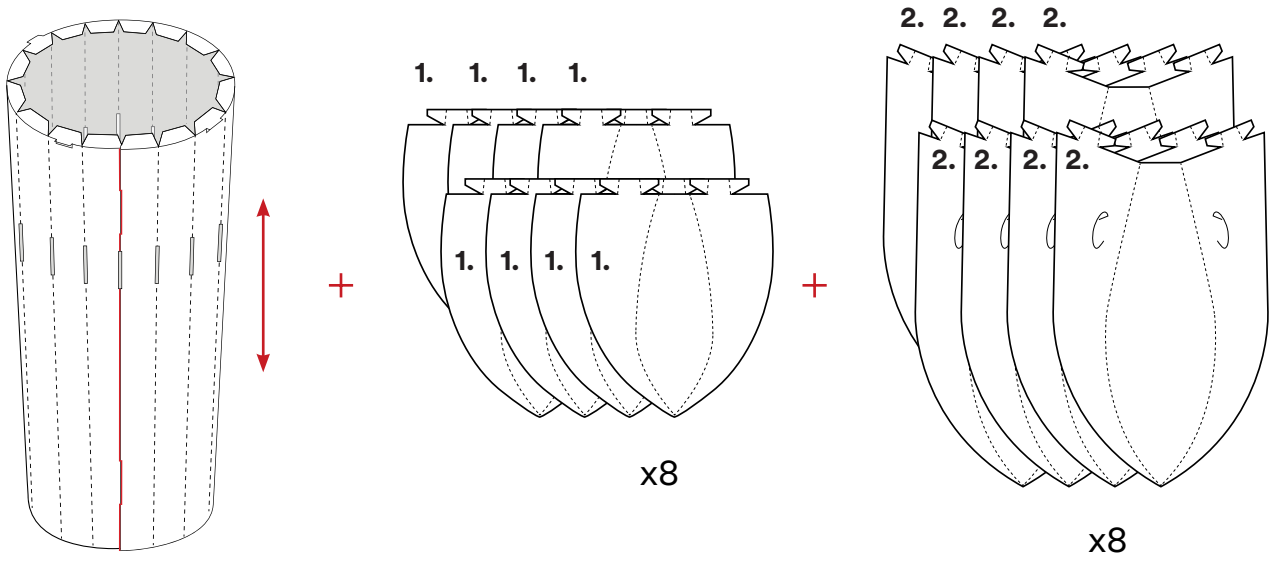

7

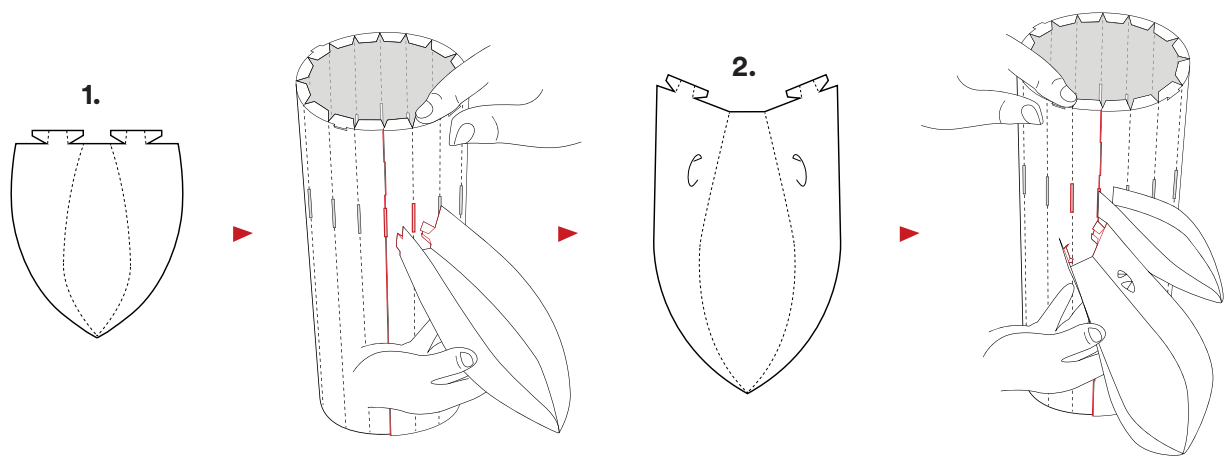

8

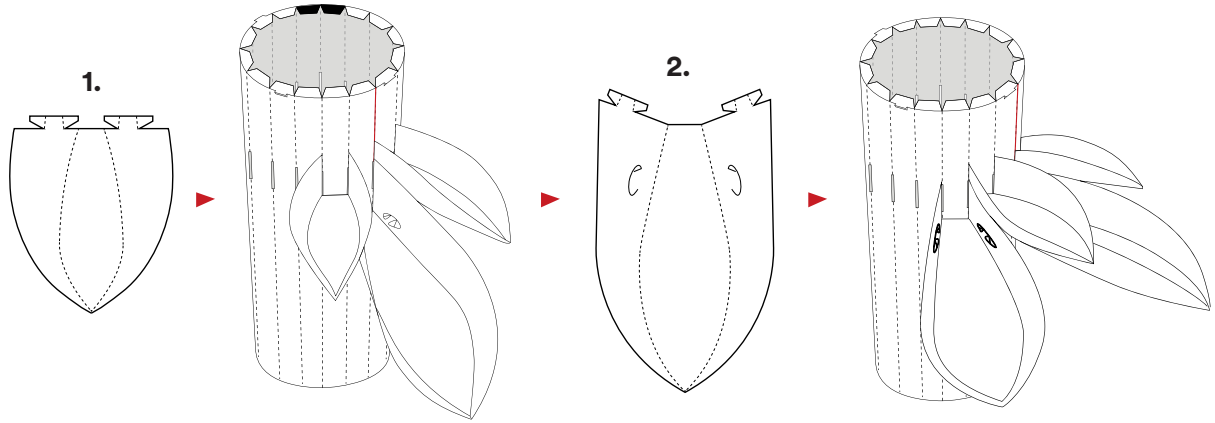

9

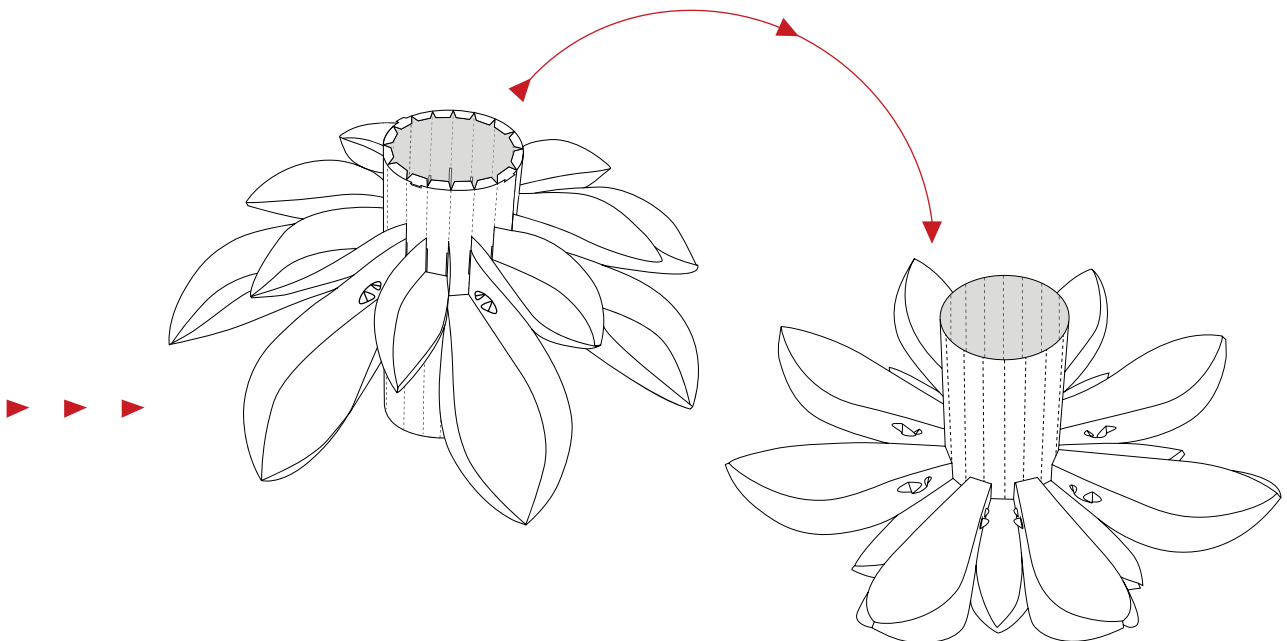

10

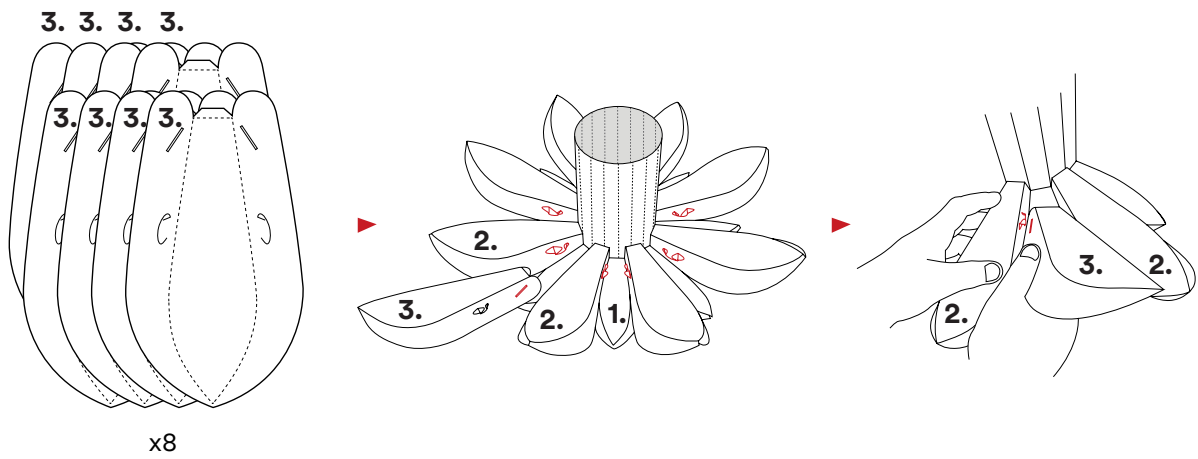

11

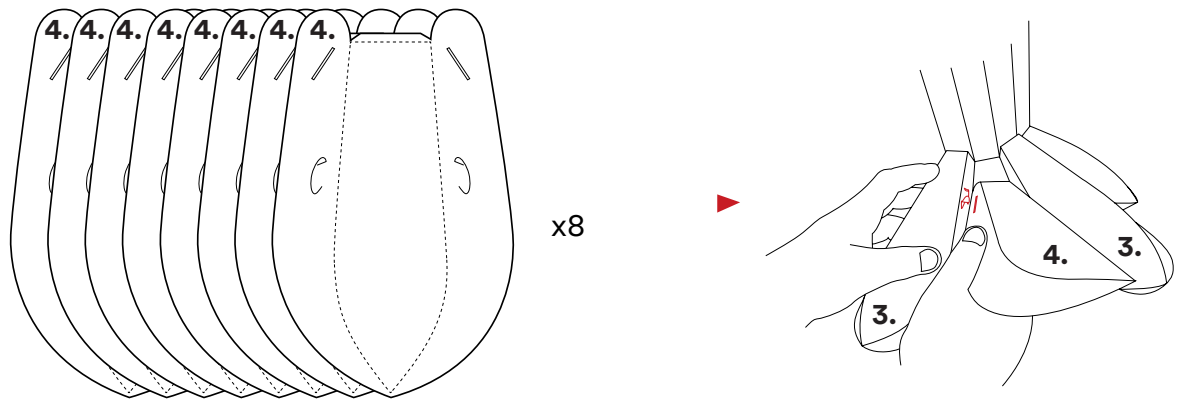

12

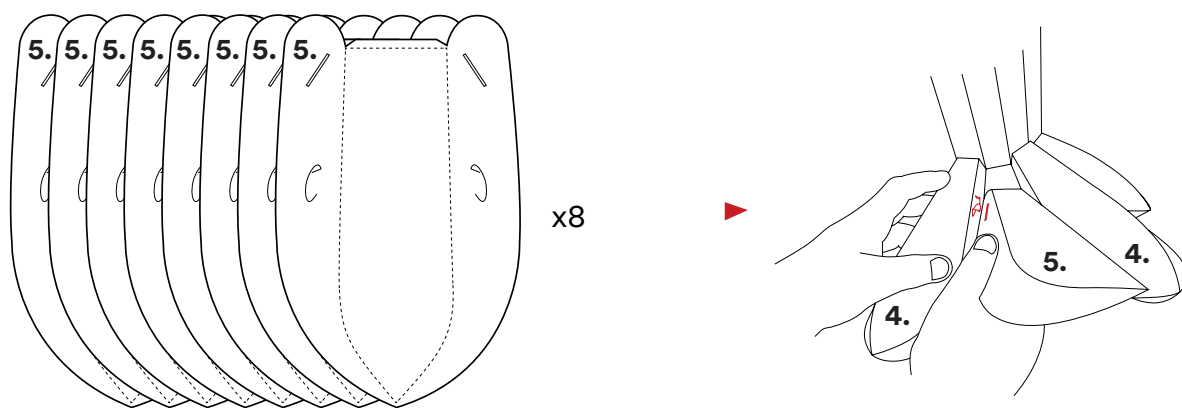

13

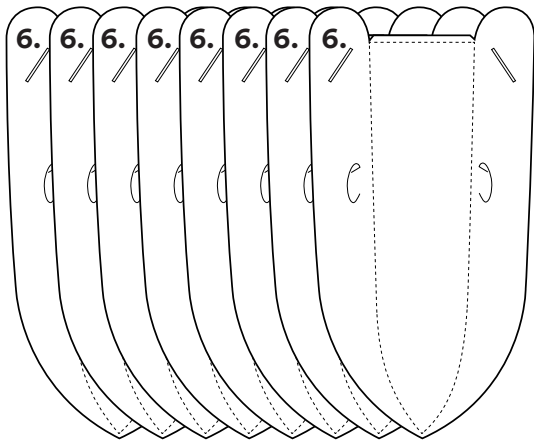

x8

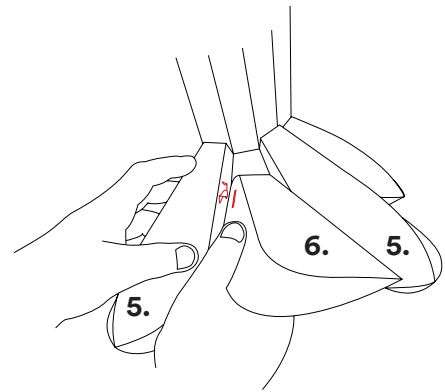

14

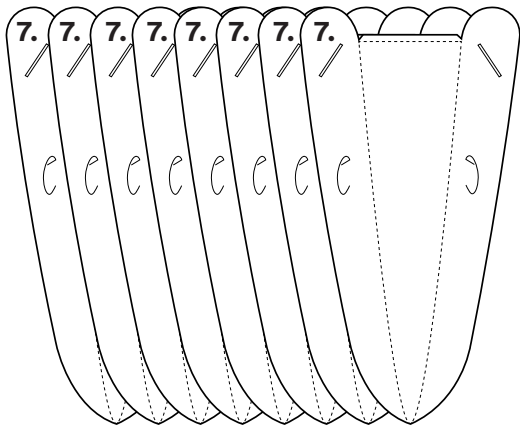

x8

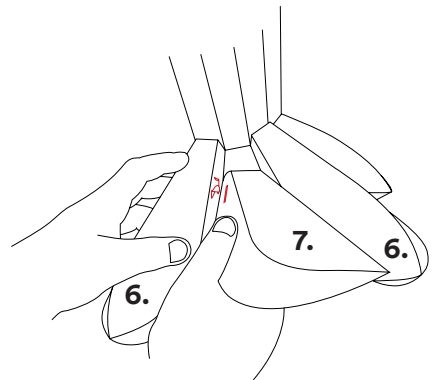

15

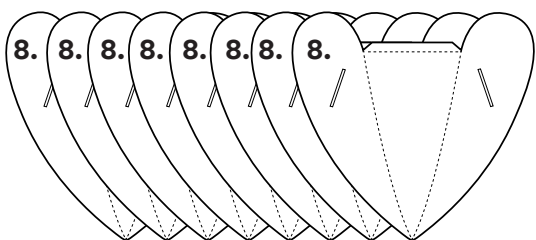

x8

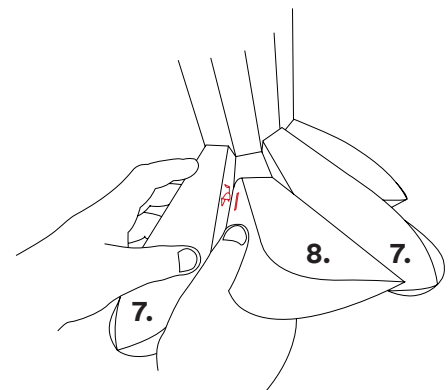

16

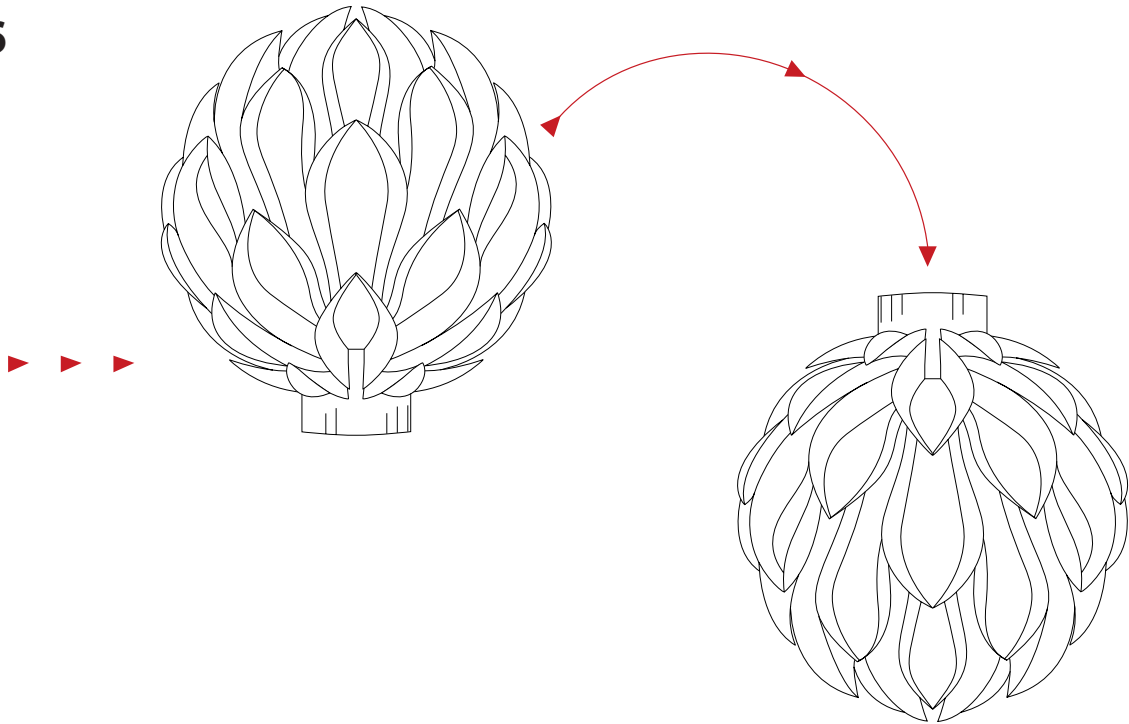

17

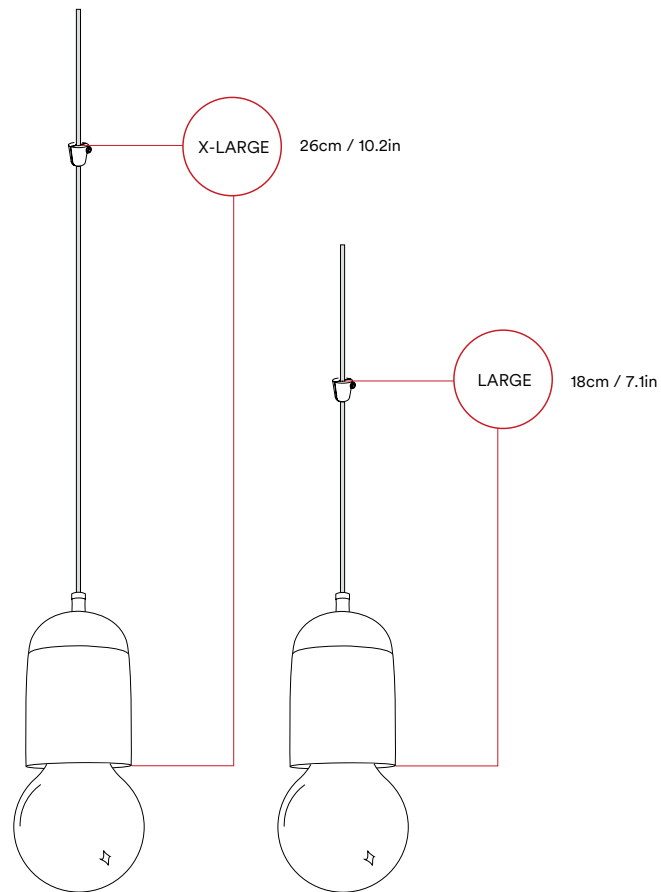

18

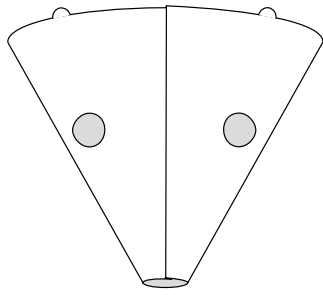

+



+

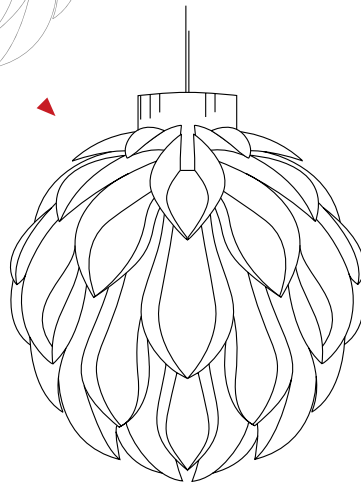
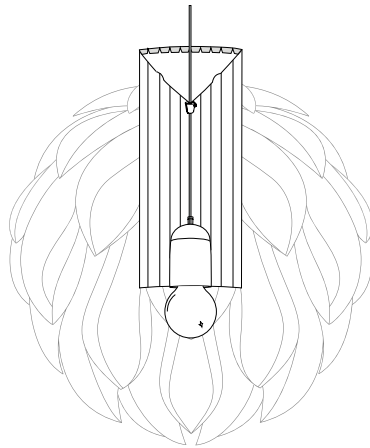
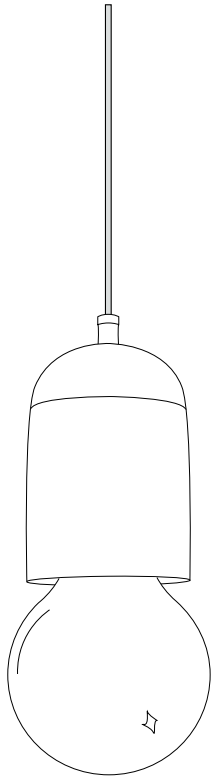

normann

C O P E N H A G E N